

## SEMICARTER

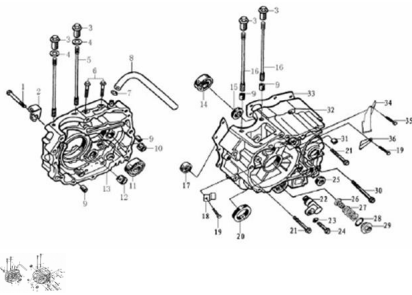

Rating: Not Rated Yet

**Price:**

Variant price modifier:

Base price with tax:

Price with discount:

Salesprice with discount:

Sales price:

Sales price without tax:

Discount:

Tax amount:

[Ask a question about this product](#)

| Description | Ref. | Título               | Código   |
|-------------|------|----------------------|----------|
|             | 1    | TORNILLO             | 61-91183 |
|             | 2    | FIJACION<br>CABLE DE | 61-22422 |
|             | 3    | TORNILLO<br>M8 X 32  | 61-91212 |
|             | 4    |                      | 61-93301 |
|             | 5    |                      | 61-91102 |
|             | 6    | TORNILLO<br>M6 X 28  | 61-B0578 |
|             | 7    |                      | 61-18097 |

| Ref. | Título                             | Código   |
|------|------------------------------------|----------|
| 8    |                                    | 61-12105 |
| 9    | PERNO<br>GUIA 10 X<br>20           | 61-91521 |
| 10   |                                    | 61-92102 |
| 11   |                                    | 61-92102 |
| 12   |                                    | 61-92102 |
| 13   |                                    | 61-1222B |
| 14   |                                    | 61-92102 |
| 15   | RETEN 20<br>X 34 X 7               | 61-90303 |
| 16   |                                    | 61-91101 |
| 17   |                                    | 61-92102 |
| 18   | PLACA<br>SUJECION                  | 61-12102 |
| 19   | TORNILLO<br>M6 X 28                | 61-B0578 |
| 20   | RETEN 34<br>X 50 X 7               | 61-90302 |
| 21   | TORNILLO<br>M6 X 40                | 61-B1667 |
| 22   | C.<br>CLAVIJA<br>SUJETA<br>PALANCA | 61-1213B |
| 23   |                                    | 61-93301 |
| 24   | TORNILLO<br>M6 X 28                | 61-B0578 |
| 25   | RETEN 14<br>X 28 X 7               | 61-90301 |
| 26   |                                    | 61-1431B |
| 27   | RESORTE<br>CILINDRO                | 61-14221 |
| 28   | O-RING                             | 61-90101 |

| Ref. | Título               | Código   |
|------|----------------------|----------|
|      |                      | 33,5 X 3 |
| 29   | TUERCA C             | 61-11230 |
| 30   | TORNILLO<br>M6 X 40  | 61-B1667 |
| 31   |                      | 61-92102 |
| 32   |                      | 61-1212B |
| 33   | JUNTA SE<br>MICARTER | 61-90208 |
| 34   | SUJECION<br>CABLE    | 61-12103 |
| 35   | TORNILLO<br>M6 X 40  | 61-B1667 |
| 36   | TOPE<br>PLACA        | 61-15108 |