

## POLEAS

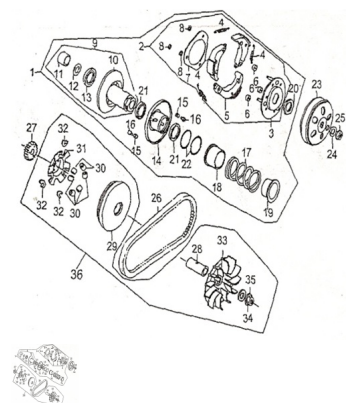

Rating: Not Rated Yet

**Price:**

Variant price modifier:

Base price with tax:

Price with discount:

Salesprice with discount:

Sales price:

Sales price without tax:

Discount:

Tax amount:

[Ask a question about this product](#)

### Description

| Ref. | Título                                  | Código       |
|------|---|--------------|
| 1    | CONJUNTO POLEA TRASERA CON EMBRAGUE 125 | 22-23300     |
| 2    | CUERPO DE EMBRAGUE 125                  | 22-21130     |
| 3    | CUERPO POLEA TRASERA 125                | 22-21110     |
| 4    | RESORTE ZAPATA DE EMBRAGUE 125          | 22-21127     |
| 5    | ZAPATA DE EMBRAGUE 125                  | 22-21120     |
| 6    | TOPE ZAPATA DE EMBRAGUE 125             | 22-21140     |
| 7    | PLACA POLEA TRASERA 125                 | 22-21132     |
| 8    | PRECINTO POLEA TRASERA 125              | 22-GB/T896   |
| 9    | CONJUNTO DISCO CONDUCTOR 125            | 22-23310     |
| 10   | DISCO CONDUCTOR 125                     | 22-23320     |
| 11   | RODAMIENTO DE AGUJA 28 X 32 X 17        | 22-GB/T290   |
| 12   | PRECINTO 28                             | 22-GB/T893.1 |
| 13   | RODAMIENTO 6902 U                       | 22-GB/T276   |

**MOTOR : POLEAS**

---

|    | Ref. | Título                              |          | Código |
|----|------|-------------------------------------|----------|--------|
| 14 |      | POLEA DELANTERA FIJA 125            | 22-23340 |        |
| 15 |      | PERNO GUIA 125                      | 22-23371 |        |
| 16 |      | RODILLO 125                         | 22-23372 |        |
| 17 |      | RESORTE POLEA TRASERA 125           | 22-23374 |        |
| 18 |      | BUJE RESORTE DE POLEA DERECHO 125   | 22-23375 |        |
| 19 |      | BUJE RESORTE DE POLEA IZQUIERDO 125 | 22-23376 |        |
| 20 |      | TUERCA M28                          | 22-23377 |        |
| 21 |      | RETEN 34 X 41 X 4                   | 22-23360 |        |
| 22 |      | O-RING POLEA TRASERA 125            | 22-23373 |        |
| 23 |      | EMBRAGUE DE SALIDA 125              | 22-21310 |        |
| 24 |      | ARANDELA 12,2 X 29 X 5              | 22-21391 |        |
| 25 |      | TUERCA M12                          | 22-21392 |        |
| 26 |      | CORREA DE DISTRIBUCION 125          | 22-23200 |        |
| 27 |      | ENGRANAJE CONDUCTIVO 20T            | 22-27231 |        |
| 28 |      | BUJE CORREA DE DISTRIBUCION 125     | 22-23141 |        |
| 29 |      | VARIADOR DE CORREA 125              | 22-23120 |        |
| 30 |      | RODILLO DE MAZA 125                 | 22-23130 |        |
| 31 |      | TAPA CON PISTA 125                  | 22-23142 |        |
| 32 |      | TACITA DE TRACCION 125              | 22-23143 |        |
| 33 |      | TURBINA VARIADOR 125                | 22-23111 |        |
| 34 |      | ARANDELA 12,2 X 29 X 2,5            | 22-23144 |        |
| 35 |      | TUERCA AUTOBLOQUEANTE M12           | 22-23145 |        |
| 36 |      | CONJUNTO POLEA CONDUCTORA 125       | 22-23100 |        |