

GRUPO BALANCIN

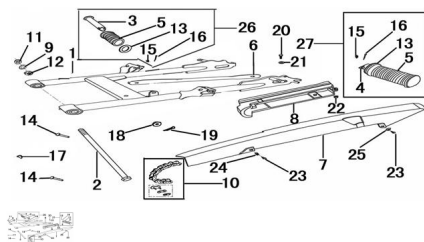

Rating: Not Rated Yet

Price:

Variant price modifier:

Base price with tax:

Price with discount:

Salesprice with discount:

Sales price:

Sales price without tax:

Discount:

Tax amount:

[Ask a question about this product](#)

Description

| Ref. | Título | Código |
|------|-----------------------------------|-----------------|
| 1 | BALANCIN | 49-61100 |
| 2 | EJE BALANCIN 255mm | 10-61214 |
| 3 | EJE PEDALIN ACOMPAÑANTE DERECHO | 10-42780 |
| 4 | EJE PEDALIN ACOMPAÑANTE IZQUIERDO | 10-2662742640 |
| 5 | GOMA PEDALIN ACOMPANANTE | 10-42761 |
| 6 | BARRA TOPE FRENO TRASERO | 10-61216 |
| 7 | CUBRECADENA ZB 110 (3) | 49-61311 |
| 8 | GUIA CADENA | 10-61215 |
| 9 | ARANDELA M10 | 10-GB96-85 |
| 10 | CADENA | 10-GB/T14212-93 |
| 11 | TUERCA M10 X 1.25 | 10-GB6173-86 |
| 12 | TUERCA M10 X 1.25 | 10-GB6173-86 |
| 13 | CUBETA PEDALIN ACOMPANANTE | 10-42763 |
| 14 | PERNO M6 X 40 | 10-GB/T882 |
| 15 | ARANDELA ø 6 | 10-GB/97.1-85 |
| 16 | SEGURO PEDALIN ACOMPANANTE | 10-42764 |
| 17 | PERNO M10 X 18 | 10-GB/T882-1 |
| 18 | ARANDELA M10 | 10-GB93-87 |
| 19 | CHAVETA 3,0 X 36 | 10-GB/T91 |
| 20 | TORNILLO M6 X 20 | 10-GB/T5783-3 |

ESTRUCTURA : GRUPO BALANCIN

| | Ref. | Título | Código |
|----|------|--------------------------------------|-----------------|
| 21 | | ARANDELA \varnothing 6 | 10-GB/97.1-85 |
| 22 | | TUERCA M6 | 10-GB6170-86-3 |
| 23 | | TORNILLO M6 X 12 | 10-GB5787-86-15 |
| 24 | | BUJE CUBRECADENA | 10-266276193 |
| 25 | | ARANDELA \varnothing 6 | 10-GB/97.1-85 |
| 26 | | PEDALIN ACOMPAÑANTE IZQUIERDO ARMADO | 10-900-2 |
| 27 | | PEDALIN ACOMPAÑANTE DERECHO ARMADO | 10-900-19 |